

ES600 series

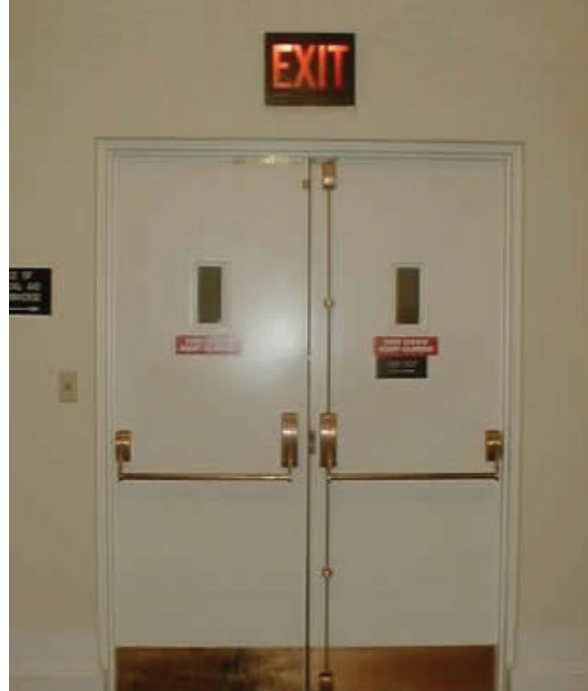

Annunciators

The ES600 series annunciators provide an efficient means of displaying the condition of security devices throughout a monitored facility. They serve to provide visual and audible indication of alarms as they occur, giving security personnel the ability to monitor a large complex from a single location.

Designed Security, Inc. Multi-Zone Annunciators utilize a modular concept to provide state-of-the-art alarm monitoring in a compact and economical package. Standard and optional control electronics are organized into four zone modules which can be grouped to provide a wide range of monitoring capabilities.

FEATURES & BENEFITS

- Easy installation
- Solid state design
- Available in 4, 8 and 12 zone configuration
- Monitors normally closed dry contacts
- 12 volt DC operation
- Global alarm output (N/O relay)
- Optional individual zone shunt
- Optional individual zone relay output
- Optional end of line supervision
- Painted off-white aluminum (custom silk screening is available - please contact factory)
- Fits in gangable box



ES600 Series

DSI[®]
DESIGNED SECURITY, INC.
A Detex Company

1402 Hawthorne St.
Bastrop, Texas 78602
Voice: 1-800-272-3555
Fax: 1-512-321-9181
E-mail: dsi@dsigo.com
www.dsigo.com

Models

| | |
|--------------|---------------------|
| ES610 | 4 Zone Annunciator |
| ES620 | 8 Zone Annunciator |
| ES630 | 12 Zone Annunciator |

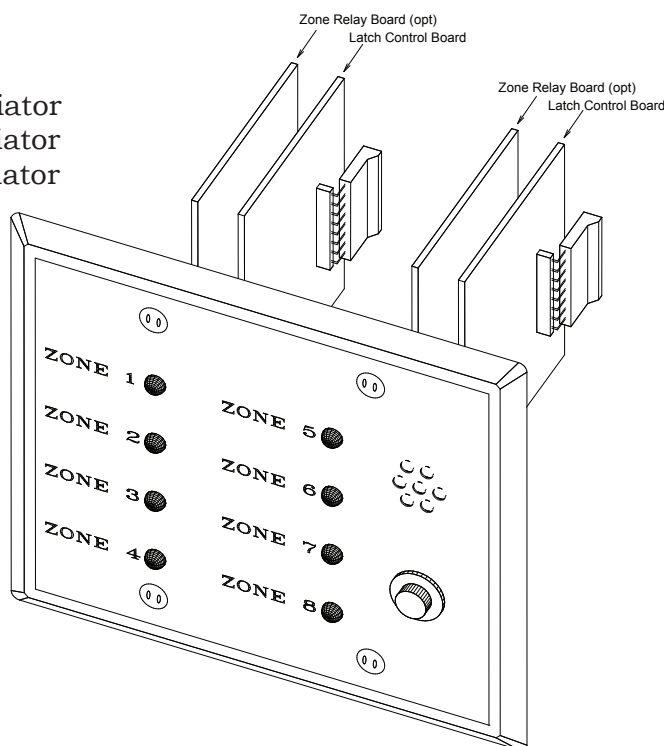

ELECTRICAL SPECIFICATIONS

| | |
|-----------------------|------------------------------------|
| Power: | 12 VDC |
| Local Control: | Alarm Acknowledge "ACK" |
| Zone Input: | N/C Dry Contacts |
| Alarm Output: | Global N/O Relay 0.5 A @ 30 VDC |

MECHANICAL SPECIFICATIONS

Mounting/Size:

| | |
|--------|---|
| 1 gang | 3.0"w x 4.6"h x 2.5"d ES610, ES611 |
| 2 gang | 4.6"w x 4.6"h x 2.5"d ES612, ES613, ES614, ES615, ES620, ES621 |
| 3 gang | 6.4"w x 4.6"h x 2.5"d ES622, ES623, ES624, ES625, ES630, ES631 |
| 4 gang | 8.2"w x 4.6"h x 2.5"d ES632, ES633, ES634, ES635 |

Trim Plate Finish: Painted off white aluminum panel with gray silk screened text. **

** Custom silk screening is available.
Please contact factory.

PRODUCT DESCRIPTION

- Latch Control** (standard)
 Alarm condition causes the zone LED to flash red, the audible to sound, and activates a global alarm contact. The annunciator remains in this mode until the alarm is acknowledged by pressing the "ACK" button. Acknowledging the alarm silences the audible, resets the global contact, and sets the zone LED to a steady "on" until the point is reset. Once the point is reset, the LED is extinguished.
- Zone Shunt** (optional)
 Enables the user to shunt (or bypass) any selected zone. The bi-color zone LED illuminates green when shunted. All un-shunted zones operate normally.
- Zone Relay** (optional)
 Provides a dry relay contact per zone. This N/O contact follows the state of the zone alarm.
- EOL Supervision** (optional)
 Line tamper activates audible sounder and separate amber "tamper" LED. Panel remains in this state until the line tamper is corrected.

DSI[®]
 DESIGNED SECURITY, INC.
 A Detex Company

1402 Hawthorne St.
 Bastrop, Texas 78602
 Voice: 1-800-272-3555
 Fax: 1-512-321-9181
 E-mail: dsi@dsigo.com
www.dsigo.com