

ADA Gate

DS336 High Security Series

Interior & Exterior Application / Manual Passage Gate

The DS336 High Security Manual Passage Gate

Series is truly custom. Available in mesh or bars, gate

can be ordered in stainless steel, powder-coated or

galvanized to match any of our full height turnstiles.

Standard width for passage gates is 36", customized

widths are available.



Push bar
not available
without mesh
DS336-PB
shown

DS336 High Security Series



DS336
(tube steel)

FEATURES AND BENEFITS

- Your choice of galvanized carbon steel, polyester enamel or 304 stainless steel
- Full exit push-bar, guard and mesh available
- Door Closer:
Norton 9300 Series with Aluminum Finish
- Deadlock:
Adams Rite 4510 Series with 31/32" Backset
- Strike:
Adams Rite 7100 Series Electronic Strike, 24VDC
- Cylinder:
Schlage C Keyway - Standard
SFIC Available

DSI[®]
DESIGNED SECURITY, INC.
Building Security

1402 Hawthorne St.
Bastrop, TX 78602
Voice: 1-800-272-3555
Fax: 1-512-321-9181
E-mail: dsi@dsigo.com
www.dsigo.com

DS336 High Security Series - Interior & Exterior Application

Applications:

Ideal for controlling orderly flow of foot traffic in both indoor and outdoor settings where an ADA Gate is required. (Matching gate to our High-Security Full Height Single and Tandem Turnstiles)

Product Features:

Materials and Finishes available in your choice of:

- Hot dipped galvanized carbon steel
- Polyester enamel on carbon steel (standard color is black. Other colors available upon request)
- Our signature 304 stainless steel/No. 4 satin finish

Design & Construction:

- Designed for secure operation with aesthetics in mind
- Featuring fully welded exterior components
- Minimal exposed hardware
- Heavy gauge materials meeting ASTM standards

Measures:

DS336-ADA

Size of Opening (pedestrian clearance)

DS336-ADA 36" (914mm)

Frames and Door Jam

2" x 3" (51mm x 76.2mm) 11 gauge box tubing

Optional 2" x 2" (51mm x 51mm) 11 gauge box tubing

Exterior Height

91" (2331mm)

Interior Height

88½" (2248mm)

Interior Tubing Sizes

Galvanized or Powder Coated Units

1½" (38mm) diameter carbon steel 14 gauge

1¾" (44mm) diameter carbon steel 14 gauge

Stainless Steel Units

1½" (38mm) diameter stainless steel 16 gauge

1¾" (44mm) diameter stainless steel 16 gauge

If Panic Bar is required, interior tubing is replaced with ¾" #9 flattened expanded metal mesh (carbon steel or stainless steel)

Options:

- Full exit push-bar, guard and mesh available
- Magnetic lock
- Electric opener (adds 2" of height to gate)
- Push button (wired or wireless)

Matching Full-Height Turnstiles available in Single (DS427-S, DS430-S, DS439-S, DS448-S) and Tandem (DS427-T and DS430-T) Designs

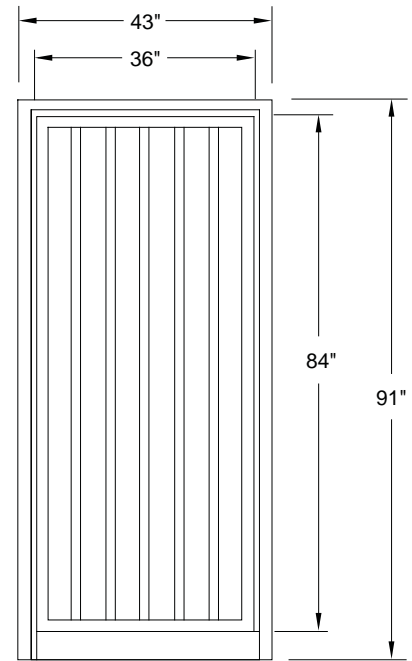

Electrical Specifications:

Operating voltage: 24 VDC

All electrical components are UL recognized and CSA certified.

Standards and Codes:

Austenitic stainless steel:
ASTM A240, A249, A276

Hot rolled steel:
AISI C-1020, AISI C-1018

Hot dipped galvanizing:
ASTM A-143, ASTM A-153-80

Stainless steel fasteners:
ASTM A-320

American Welding Society (AWS)
Standard D1.1

Warranty:

Units are warranted against defects in materials and workmanship for a period of one year from date of invoice.



1402 Hawthorne St.
Bastrop, TX 78602
Voice: 1-800-272-3555
Fax: 1-512-321-9181
E-mail: dsi@dsigo.com
www.dsigo.com